



# **USE AND CARE GUIDE**

**Piggyback Tethered Float Switch**

**Model # RTFS-10**



## SAFETY INFORMATION:



**WARNING**

**ALWAYS DISCONNECT POWER TO YOUR PUMP AND RELEASE PRESSURE BEFORE SERVICING.**

## SPECIFICATIONS

Tether Length (Inches)	3.5 (Min)	6	9	12	15	18	22 (Max)
Pumping Range (Inches)	8	11	15	21	28	31	36

## INSTALLATION

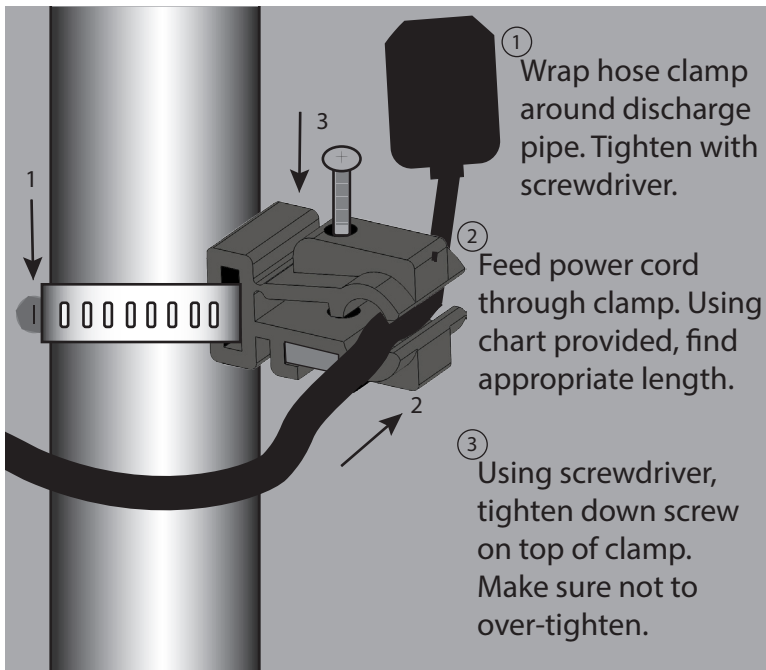

## INSTALLATION

Determine and set tether length  
(Length needed may vary depending on  
product specifications).

*Activation Point: 45°*

*Adjustable Tether Length*

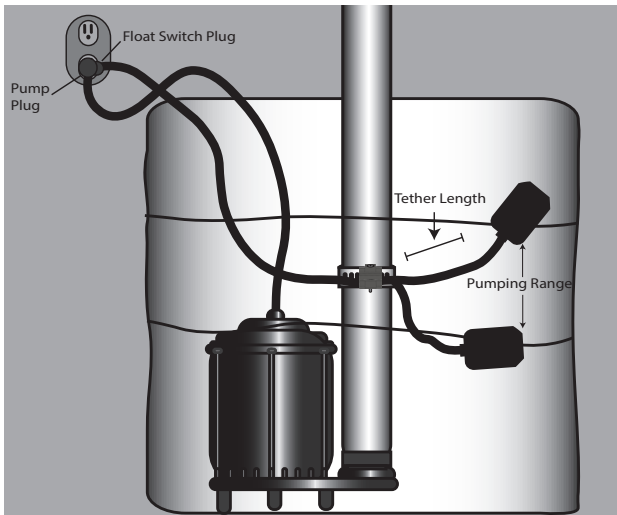
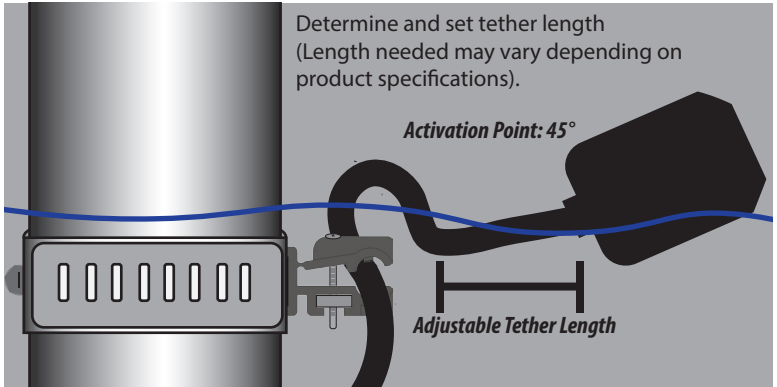

**MAKE SURE:**  
To allow system to cycle to ensure everything is working properly

**MAKE SURE:**  
To have a minimum tether length of 3.5 inches

## ***Limited Three-Year Warranty***

### **WHAT THIS WARRANTY COVERS:**

When used and maintained in normal use and in accordance with the Owner's Manual, your RAYBEND® product is warranted against original defects in material and workmanship for a full three years from the date of purchase (the "Warranty Period"). During the Warranty Period, RAYBEND® will repair or replace at no cost to you, to correct any such defect in products found upon examination by RAYBEND® to be defective in materials or workmanship.

### **WHAT THIS WARRANTY DOES NOT COVER:**

Use of the product in a non-residential application, improper installation and/or maintenance of the product, damage due to misuse, acts of God, nature vandalism or other acts beyond control of RAYBEND®, owner's acts or omissions, use outside the country in which the product was initially purchased and resales of the product by the original owner. This warranty does not cover pick up, delivery, transportation or house calls. However, if you mail your product to a RAYBEND® Sales and Service Center for warranty service, cost of shipping will be paid one way. This warranty does not apply to products purchased outside of the United States, including its territories and possessions, outside of U.S. Military Exchange and outside of Canada. This warranty does not cover products purchased from a party that is not an authorized retailer, dealer or distributor of RAYBEND® products.

### **OTHER IMPORTANT TERMS:**

This warranty is not transferable and may not be assigned. This Warranty shall be governed and construed under laws of the state of Michigan. The Warranty Period will not be extended by any replacement or repair performed under this Warranty. THIS WARRANTY IS THE EXCLUSIVE WARRANTY AND REMEDY PROVIDED BY RAYBEND®. ALL OTHER WARRANTIES, EXPRESSED OR IMPLIED, INCLUDING WARRANTIES OR MERCHANTABILITY OR FITNESS FOR PARTICULAR PURPOSE, ARE DISCLAIMED. IN NO EVENT WILL RAYBEND® BE LIABLE FOR ANY SPECIAL, INDIRECT, INCIDENTAL OR CONSEQUENTIAL DAMAGES OF ANY KIND OR NATURE TO OWNER OR ANY PARTY CLAIMING THROUGH OWNER WHETHER BASED IN CONTRACT, NEGLIGENCE, TORT, OR STRICT PRODUCTS LIABILITY OR ARISING FROM ANY CAUSE WHATSOEVER. Some states do not allow for the exclusion of consequential damages, so the above exclusion may not apply to you. This warranty gives you specific rights. You may also have other that vary from state to state.



2723 Kersten Court • Kalamazoo, Michigan 49048 • 269-254-8497  
[www.RAYBEND.com](http://www.RAYBEND.com)